

Post 56 Convertible

The Tradition Continues



POST  YACHTS
YACHTS OF QUALITY, NOT QUANTITY SINCE 1957

A Tradition Of Excellence For Nearly Half A Century.

Post 56 Convertible

With All The Refinements You've Come To Expect In A Quality Yacht.

When Post began building boats back in 1957, they were hand built of wood. Though the hull and topsides are now constructed of low maintenance fiberglass, Post's interiors remain flavored with the finest hand-fitted joinery in the industry, widely imitated yet rarely challenged.

Discover The Difference

Unlike the modular construction techniques used by many of today's yacht manufacturers, the Post 56 is built one piece at a time, one yacht at a time. It takes longer to build a yacht this way, but the resulting quality is what has always set Post apart.

Into the 56's brawny hull, with its hand-laid solid fiberglass bottom, the bulkheads are individually fitted



and reinforced with additional glass matting to further ensure the yacht's integrity and long-term durability.

Experience The Difference

It's often difficult to get a true feel for any yacht from a brochure or web site. With that in mind, we would like to invite you to step aboard a New 56 and experience the difference firsthand. Take the time to

examine the overall workmanship and attention to detail, and if time allows, take the helm and further experience a level of performance and responsiveness second to none.

You can see the New 56 Convertible, along with our 42, 47 and 50 foot models, at your nearest Post Dealer.





*Spacious Forward Seating
With Stowage Below*



*Centerline Helm
Provides Excellent
360 Degree Visibility*



*Tournament Size
Cockpit Features
Molded Transom Fishwell*



*Superb Handling
Characteristics
In All Sea Conditions*

Superb Performance

Post lists cruising speeds in the mid-30-knot range, with top speeds in the upper 30-knot range depending on conditions. The 56 is powered by 12-cylinder diesels, and responds nicely with the standard hydraulic steering. For those skippers seeking the finger touch control and handling characteristics of a sports car, optional power assisted steering is available.

Built To Endure

Hand-laid construction includes a solid keel, bottom and chines. Vinylester resins are used in the first two hull layers to prevent blistering and osmosis. Above the waterline, the 56's hull is cored with closed-cell PVC foam. On the outside, Isophthalic gel coat gives the yacht's surface a deep gloss finish that will stand up to tough marine environments.





▲ **Galley** (above): The galley is outfitted with a Corian countertop, convection microwave and an electric cook top. An under counter refrigerator and freezer (shown with optional drawers) are located in the galley island to maximize space and convenience. Indirect lighting casts a soft glow across the bookend matched joinery. Teak parquet floor is standard.



Post has been long known for its low volume/high quality production. That continuing philosophy is reflected in the yacht's strong resale value.



◀ **Salon** (left): The expanded deckhouse is especially spacious as the yacht carries its nearly 17-foot beam well aft. Entering the salon and immediately to starboard is a two-tier electrical panel that handles the yacht's AC and DC systems. Fitted into the joinery below is an optional built-in icemaker. Accommodations are plush and inviting with an optional U-shaped lounge to port (L-shaped lounge is standard) and a settee and dinette to starboard opposite the U-shaped galley.

▲ **Underway** (above): The hull with moderate deadrise has a sharp entry and molded chines making it well suited for offshore work. The distinct windshield rake, which accentuates the wings and front of the flying bridge, creates a dynamic and sleek profile that will please ardent sportfishermen and sophisticated cruising yachtsmen.



▲ **Master Stateroom** (above): The master stateroom with a queen-sized island bed is on the port side. Under berth stowage is complemented with a cedar-lined hanging locker and a wall of drawers that also includes a built-in television. A private head offers a molded countertop with a recessed sink and a fiberglass stall shower with seat and linen cabinet.



▲ **Forward Stateroom** (above): Has a lower double berth and a single upper berth with cedar-lined hanging lockers, an arrangement that is attractive to long-range fishermen and cruising couples. This stateroom has private access to the second head, which also can be reached from the offset companionway.



▲ **Master Head** (above): Accessed through the owner's stateroom.

Located on the companionway (to starboard), a washer/dryer is neatly tucked out of site.



▲ **Guest Stateroom** (above): To starboard, the guest stateroom features upper and lower berths with drawers below and a deep hanging locker

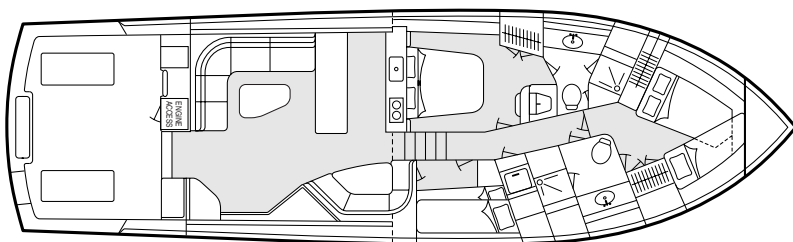

Some pictures shown contain optional features.

Length, Overall (L.O.A.)	55'11"	17.05 m
Length, Waterline (L.O.W.)	50'4"	15.34 m
Beam	16'11"	5.16 m
Draft	5'6"	1.68 m
Freeboard, Forward	6'	1.83 m
Freeboard, Aft	3'	.91 m
Fuel Capacity	1,200 Gals.	4,542.1L
Water Capacity	250 Gals.	946.3L
Holding Tank Capacity	80 Gals.	302.8L
Gross Weight	66,830 Lbs.	30,340 kg
Height, Waterline To Top Of Flybridge Console	14'3"	4.34 m
Height, Waterline To Top Of Hardtop	17'6"	5.33 m

Note: Post reserves the right to make changes in design, equipment, layout and/or construction without notice.

Post 56 Convertible

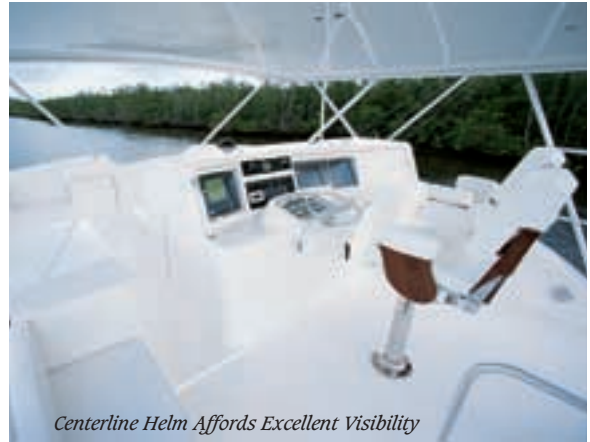

Centerline Helm Affords Excellent Visibility



Tackle Locker & Rigging Station



Cockpit Engine Room Access



56 Engine Room



Top Loading Bait Freezer

Designed For Tournament Action, The Fifty-six Sports A Massive Bridge & Cockpit.

Expansive Bridge

A polished anodized aluminum ladder passes through the cabin roof to the flying bridge for safe access while saving space in the cockpit. The visibility from the bridge is excellent, and important items including molded nonskid and sturdy grab rails have not been overlooked. Two helm seats are standard, and there is ample room to walk behind the seats to reach the rocket launcher on the aft railing. Bench seating ahead of the helm console and to port features dry stowage below for gear and fishing rods. The helm, with its single lever controls and room for a bank of flush-mounted electronics, was designed to please the most ardent skipper.

All Business Cockpit

The cockpit is over 12 feet long and outfitted with tackle stowage, a top loading bait freezer, fresh and saltwater washdown systems, two below deck fishwells, a molded transom fishwell, transom door and engine room access. The deck features a durable nonskid, and anchors the biggest



fighting chair with ease thanks to reinforced solid-mahogany laminated into the fiberglass sole. The bridge overhang shades the cockpit, while providing safe and easy access to the helm.

Easy Maintenance Engine Room

Accessed through the cockpit, the 56's engine room is another example of Post's astute engineering. Gel coated for easy care, the entire work space is brightly lit with dual-voltage lighting. All machinery installations were designed for trouble-free service and easy maintenance—whether replacing a fuel filter or changing oil in the engines' standard 20kW generator.

POST YACHTS
YACHTS OF QUALITY, NOT QUANTITY SINCE 1957