

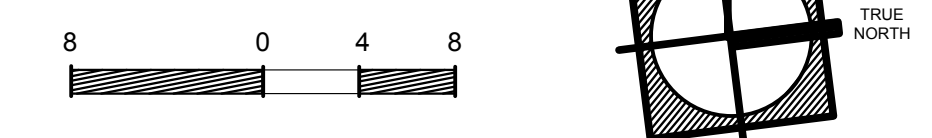

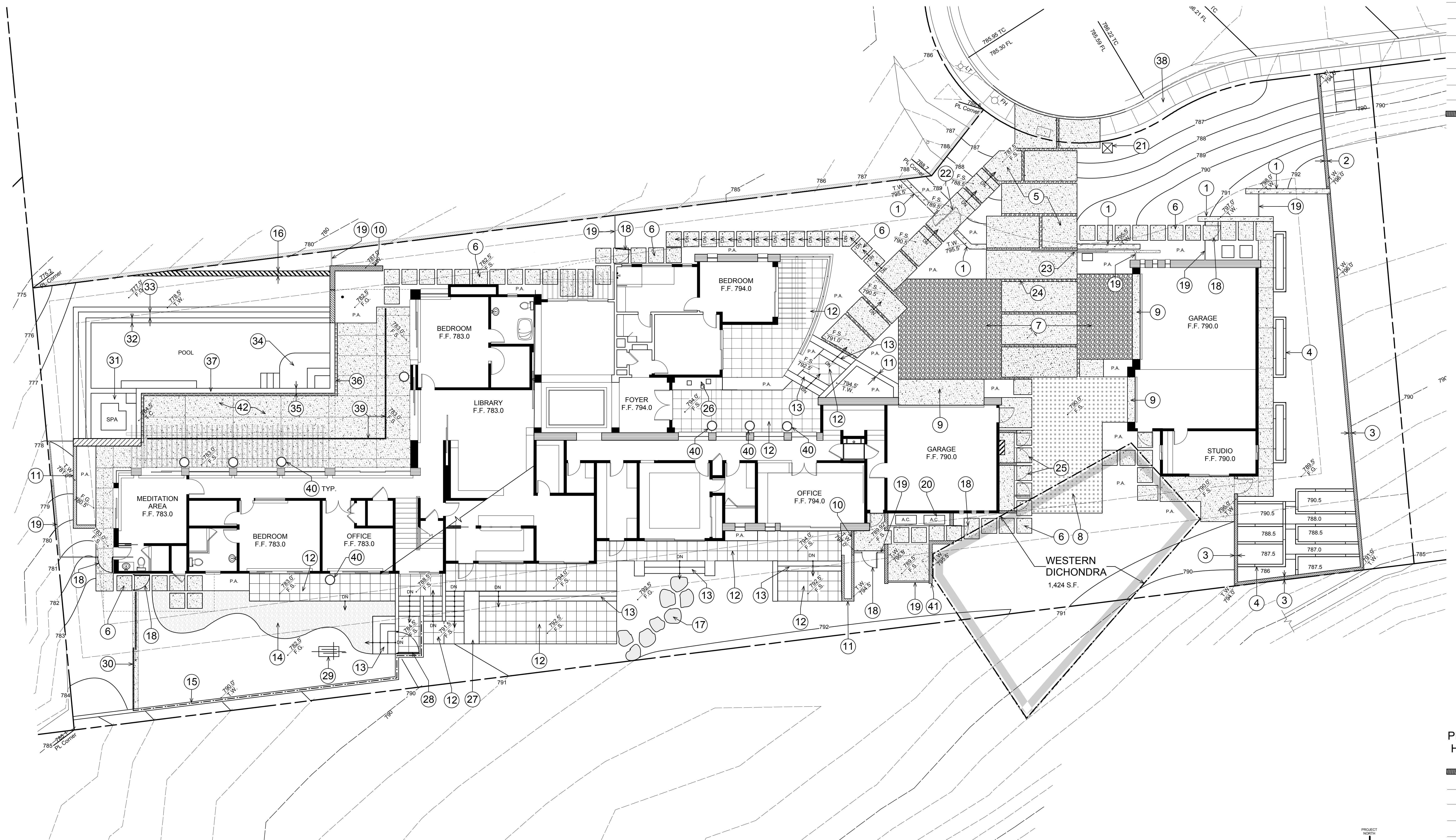



CONSTRUCTION NOTES

1. 12" WIDE FORMED IN PLACE CONCRETE WALL TO MATCH ARCHITECTURE
2. 4'-0" HIGH CONCRETE BLOCK WALL WITH STUCCO FINISH TO MATCH ARCHITECTURE
3. 6'-0" HIGH CONCRETE BLOCK WALL WITH STUCCO FINISH TO MATCH ARCHITECTURE
4. 6" WIDE X 13" HIGH X 6' LONG NATURAL CUT STONE FOR RAISED VEGETABLE GARDEN
5. 6" THICK POURED IN PLACE CONCRETE DRIVEWAY PADS WITH SANDBLAST FINISH
6. 4" THICK X 3' SQUARE POURED IN PLACE CONCRETE PADS. STEP WITH GRADE
7. TURF BLOCK CONCRETE PADS (2' X 3') WITH 1" DIAMETER PEBBLE COVER
8. TURF BLOCK CONCRETE PADS (2' X 3') WITH DICHONDRA SOD
9. 6" THICK POURED IN PLACE CONCRETE HEADER IN FRONT OF GARAGE DOOR
10. 7'-0" HIGH CONCRETE BLOCK SCREEN WALL WITH STUCCO FINISH
11. 2' HIGH CONCRETE BLOCK PLANTER WALL WITH STUCCO FINISH
12. 2' X 2' TILE STONE PAVERS TO MATCH INTERIOR
13. 12" X 2" TILE STONE TREADS & RISERS
14. 3/4" DIAMETER DECORATIVE GRAVEL GROUNDCOVER
15. 8'-0" HIGH CONCRETE BLOCK RETAINING WALL WITH VERTICAL PLANTERS. 42" HIGH WIRE CABLE GUARDRAIL ON RETAINING WALL
16. CONCRETE BLOCK RETAINING WALL WITH STUCCO FINISH TO MATCH ARCHITECTURE
17. 2' X 3' NATURAL STONE STEPPING PADS
18. 3'-0" WIDE X 6'-0" HIGH SELF CLOSING WROUGHT IRON GATE
19. 6'-0" HIGH WROUGHT IRON FENCE
20. AIR CONDITIONING UNITS
21. 4'-0" HIGH X 24" SQ MAILBOX WITH RECESSED LIGHT
22. 5'-0" WIDE X 6'-0" HIGH PIVOTING STAINLESS STEEL GATE
23. 6'-0" HIGH X 17' WIDE AUTOMATED SLIDING GATE
24. 1" DIAMETER PEBBLES RECESSED 1/2" BELOW PAVING
25. 7'-0" HIGH GATES AND WALLS WITH STUCCO FINISH (TRASH ENCLOSURE)
26. 8'-0" HIGH X 9'-0" WIDE WATER WALL WITH 12" DEEP WATER BASIN WITH OVERFLOW & AUTOMATED RECIRCULATING PUMP
27. CONCRETE COUNTER TOP
28. 4'-0" WIDE X 7'-0" HIGH SELF CLOSING WROUGHT IRON GATE
29. SCULPTURE AS PROVIDED BY OWNER
30. 6'-0" HIGH WROUGHT IRON ROLLING GATES
31. 9'-0" X 9'-0" SPA WITH 12-JETS AND AIR SWITCH
32. NEGATIVE EDGE BOND BEAM WITH CUT STONE VENEER
33. LOWER BASIN WITH TILE FINISH
34. UNDERWATER BAJA BENCH
35. 18" HIGH RAISED BOND BEAM WITH CUT STONE VENEER AND NEGATIVE EDGE
36. BELOW DECK OVERFLOW CHANNEL 6" WIDE X 6'-0" HIGH WITH 2" DIAMETER COBBLE STONE COVER
37. 15' LONG X 18" DEEP UNDERWATER BENCH
38. CONCRETE SIDEWALK
39. 1" WIDE SLOT DRAIN FOR POOL DECK AREA
40. 30" DIAMETER FIBERGLASS PLANTERS
41. 6'-0" HIGH CONCRETE BLOCK WALL WITH STUCCO FINISH & 4" THICK SMOOTH CONCRETE SLAB WITH DRAIN (DOG RUN)
42. 4" THICK CONCRETE POOL DECK WITH SANDBLAST FINISH



LIGHTING LEGEND

SYMBOL QTY.

-  9 FLOOD DOWN LIGHT MOUNTED IN TREE, AS MANUFACTURED BY AURORALIGHT INDUSTRIES, COPPER FLOOD LIGHT 'KENTIA' WITH 2.5 WATT LED.
-  3 MICRO WELL LIGHT AS MANUFACTURED BY AURORALIGHT INDUSTRIES, LED MICRO WELL LIGHT, MACHINED BRASS WELL LIGHT WITH 2.5 WATT LED, HEX BAFFLE.
-  13 PATH LIGHT AS MANUFACTURED BY AURORALIGHT INDUSTRIES, MACHINED COPPER PATH LIGHT 'CENTINELA' WITH 2.5 WATT LED.
-  11 WALL LIGHT AS MANUFACTURED BY AURORALIGHT INDUSTRIES, MACHINED COPPER WALL LIGHT 'MERIDIAN' WITH 1.25 WATT LED.
-  1 UNDERWATER LIGHT AS MANUFACTURED BY SPJ LIGHTING INC., CAST BRASS UNDERWATER LIGHT 'SPJ13-14' WITH 20 WATT HALOGEN.

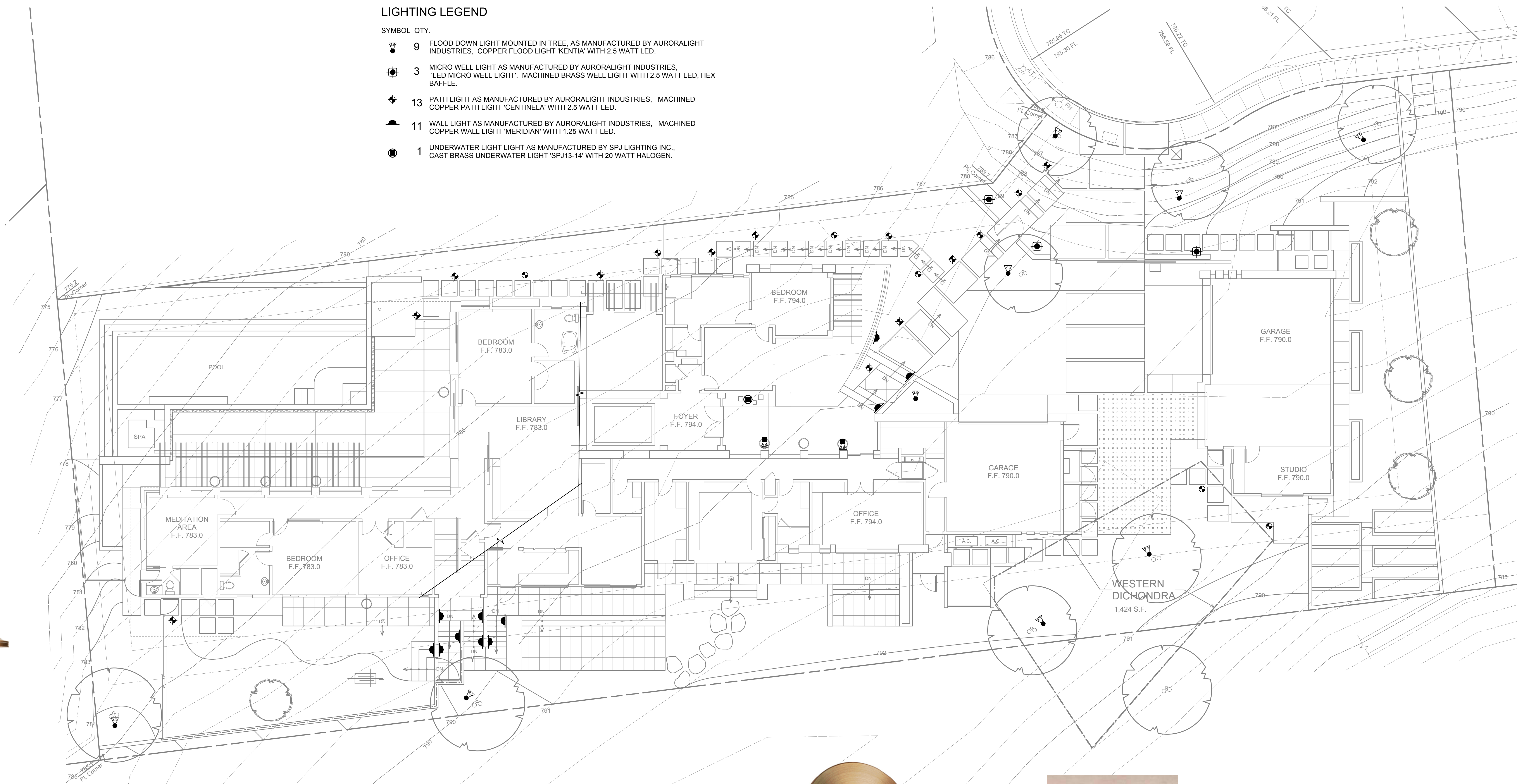

MACHINED SOLID COPPER/BRASS LED PATH LIGHT 'CENTINELA' 2.5W LED



MACHINED SOLID BRASS LED DOWN FLOOD LIGHT 'KENTIA' 2.5 W TREE STRAP AMS-T/S



MACHINED SOLID BRASS LED RECESSED MICRO WELL LIGHT '2.5W

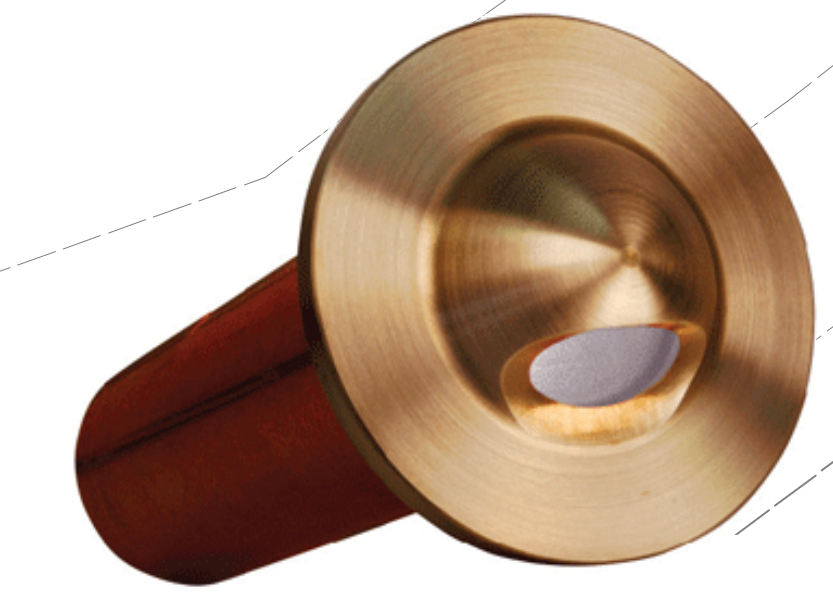

COPPER LED WALL LIGHT 'MERIDIAN' 1.25 W



BRASS UNDERWATER LIGHT (SPJ13-14)

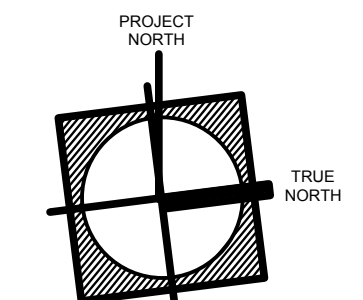
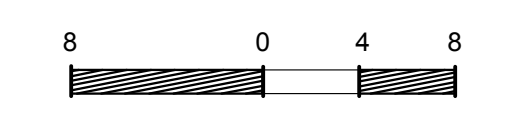

STUDIO
LANDSCAPE ARCHITECTURE STUDIO
1506 s. coast highway
laguna beach, ca 92651
949 / 494 - 0244
Fax 949 / 494 - 6150
california license 1921

WU RESIDENCE
741 BARRACUDA WAY
LAGUNA BEACH, CA.

PRELIMINARY LIGHTING PLAN
DESIGNED BY CRAIG DE PFYFFER
DATE: SEPTEMBER 26, 2012
SCALE: 1/8" = 1' - 0"
FILE NAME: Wu_Preliminary_1-22-13.vwx
SHEET **L-3** OF 4

Zone A – Setback Irrigated Zone

The purpose of the setback zone is to provide a defensible space for fire suppression forces and to protect structures from radiant and convective heat. **No combustible construction shall be allowed within the 20-foot setback zone (Zone A). In no case shall Zone A be less than 20-foot minimum.** This measurement shall be made horizontally from the point of the structure closest to Zone A. This zone is located between Zone B and the structure and in all directions (360°) surrounding the structure to include the front, side and rear yards.

Zone A – Specific Requirements

- A. Automatic irrigation systems to maintain healthy vegetation with high moisture content.
- B. Irrigation maintained outside the drip line of native oak trees.
- C. Pruning of foliage to reduce fuel load, vertical continuity, and removal of plant litter and dead wood.
- D. Complete removal of fire prone plant species (see Attachment 7), minimal allowance for retention of selected native vegetation.
- E. Plants in this zone shall be fire resistant and selected from the Fuel Modification Zone Plant List for the setback zone and given geographical area (see Attachment 8).
- F. Trees and tree form shrub species are not allowed within 10 feet of combustible structures (measured from the edge of a full growth crown).
- G. Trees and tree form shrub species are not allowed to extend beyond the property line (measured from the edge of a full growth crown).
- H. Tree and tree form shrub species are not allowed within 10 feet of adjacent tree species as measured from the edge of a full growth crown (see Attachment 6).
- I. Special consideration should be given for rare and endangered species, geologic hazards, tree ordinances, or other conflicting restrictions.
- J. Maintenance including ongoing removal and/or thinning of undesirable combustible vegetation, replacement of dead/dying fire resistant plantings, maintenance of the operations integrity and programming of the irrigation system, regular trimming to prevent ladder fuels.
- K. A minimum of 36" of horizontal clearance and unlimited vertical clearance around the exterior of the structure (360°) shall be provided for Firefighter access. Firefighter access shall be made without the need for special tools (ladders) or ability and have permanent improvements installed when ascending or descending from street level (e.g., stairs).
- L. No combustible construction shall be allowed in Zone A
- M. No permanent or portable barbecues/grills, fire pits, fireplaces or other flame generating device shall be permitted within 30' of non-fire resistive plants/vegetation.
- N. No vines shall be permitted on combustible structures (e.g., Type V non-rated structure).

Orange County Fire Authority
Fuel Modification Plans and Maintenance
Page 22 of 36
Guideline C-01
July 9, 2004

**Attachment 6
TREE AND TREE-FORM SHRUB PRUNING AND SPACING
FOR NEW PLANTINGS AND THINNING ZONES**

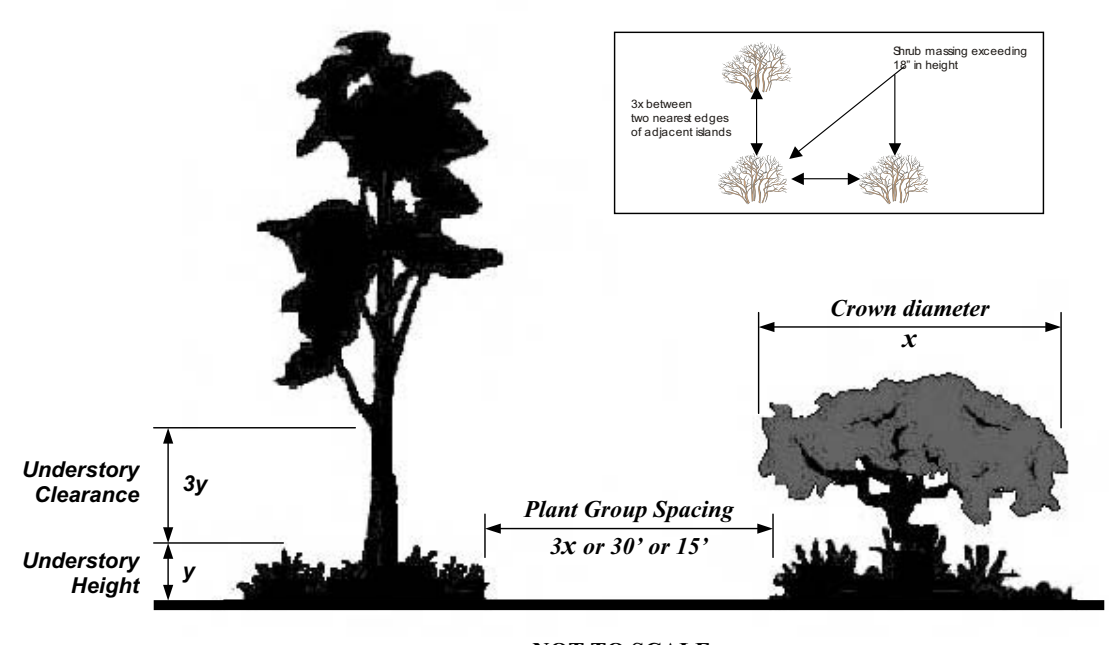

1. Understory Clearance: New and existing trees and tree-form shrubs (usually reaching 4' and taller), which are being retained with the approval of the agency having jurisdiction, shall be pruned to specific clearances of three times the height of the understory plant material or 10 feet, whichever is greater (see figure above). New trees and tree-form shrubs may comply with the lesser of sufficient height to not be available to wildlife or 10 feet. Dead and excessively irregular growth shall be removed.
2. Plant Group Spacing:
 - a. Trees and tree-form shrubs shall be single specimens or in a maximum grouping of three plants. Groupings shall be separated by a distance of three times the diameter of the largest individual mature crown or 15 feet, whichever is greater (see figure above). Other limited grouping arrangements and spacing may be acceptable if approved by OCF.A.
 - b. Trees shall be single specimens or in a maximum grouping of three plants. Groupings shall be separated by a distance of three times the diameter of the largest individual mature crown or 30 feet, whichever is greater (see figure above). Other limited grouping arrangements and spacing may be acceptable if approved by OCF.A.
 - c. Plant specimens listed in the OCF.A. Approved Plant Species/Qualification Statements for Select Plant Species shall comply with plant groupings and spacing requirements specified in those restrictions (see page 36).

Rev: 7/04

**Attachment 7
FIRE PRONE PLANT SPECIES (MANDATORY REMOVAL)**

Botanical Name	Common Name
Cynara Cardunculus	Artichoke Thistle
Ricinus Communis	Castor Bean Plant
Cirsium Vulgare	Wild Artichoke
Brassica Nigra	Black Mustard
Silybum Marianum	Milk Thistle
Sarcola Austalis	Russian Thistle/Tumbleweed
Nicotiana Bigevelii	Indian Tobacco
Nicotiana Glauca	Tree Tobacco
Lactuca Scariola	Prickly Lettuce
Conyza Canadensis	Horseweed
Heterotheca Grandiflora	Telegraph Plant
Anthemis Cotula	Mayweed
Urtica Urens	Burning Nettle
Cardaria Draba	Noary Cross, Perennial Peppercress
Brassica Rapa	Wild Turnip, Yellow Mustard, Field Mustard
Adenostoma Fasciculatum	Chamise
Adenostoma Sparsifolium	Red Shanks
Cortaderia Selloana	Pampas Grass
Artemisia Californica	California Sagebrush
Eriogonum Fasciculatum	Common Buckwheat
Salvia Mellifera	Black Sage
Ornamental:	
Corraders	Pampas Grass
Cyperus sp	Cyperus
Eucalyptus sp	Eucalyptus
Juniperus sp	Juniper
Pinus sp	Pine

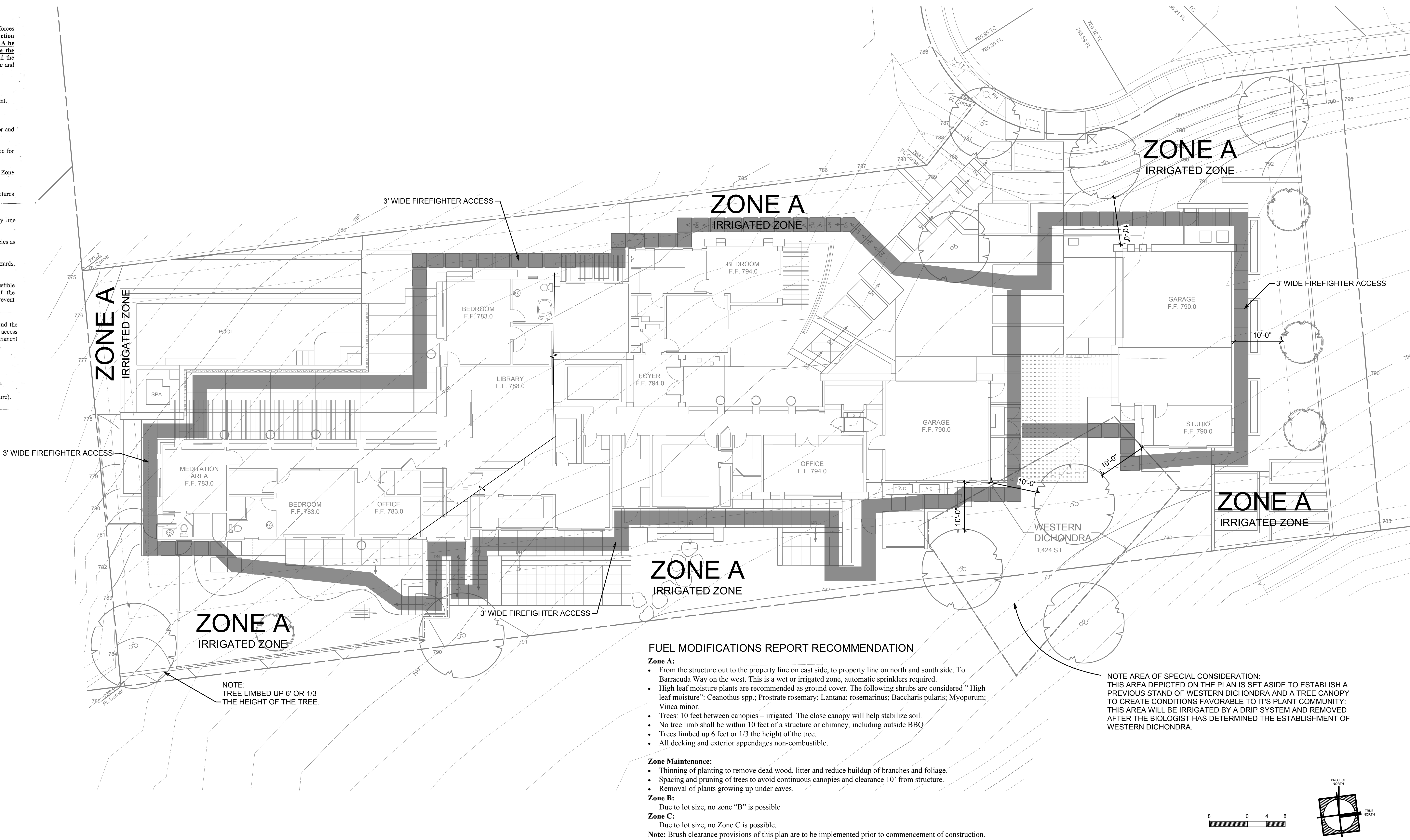

FUEL MODIFICATIONS REPORT RECOMMENDATION

- Zone A:**
- From the structure out to the property line on east side, to property line on north and south side. To Barracuda Way on the west. This is a wet or irrigated zone, automatic sprinklers required.
 - High leaf moisture plants are recommended as ground cover. The following shrubs are considered " High leaf moisture": Ceanothus spp., Prostrate rosemary, Lantana, rosemarius, Baccharis pularis, Myoporum, Vinca minor.
 - Trees: 10 feet between canopies – irrigated. The close canopy will help stabilize soil.
 - No tree limb shall be within 10 feet of a structure or chimney, including outside BBQ
 - Trees limbed up 6 feet or 1/3 the height of the tree.
 - All decking and exterior appendages non-combustible.
- Zone Maintenance:**
- Thinning of planting to remove dead wood, litter and reduce buildup of branches and foliage.
 - Spacing and pruning of trees to avoid continuous canopies and clearance 10' from structure.
 - Removal of plants growing up under eaves.
- Zone B:**
- Due to lot size, no zone "B" is possible
- Zone C:**
- Due to lot size, no Zone C is possible.
- Note:** Brush clearance provisions of this plan are to be implemented prior to commencement of construction.

NOTE AREA OF SPECIAL CONSIDERATION:
THIS AREA DEPICTED ON THE PLAN IS SET ASIDE TO ESTABLISH A PREVIOUS STAND OF WESTERN DICHONDRA AND A TREE CANOPY TO CREATE CONDITIONS FAVORABLE TO ITS PLANT COMMUNITY. THIS AREA WILL BE IRRIGATED BY A DRIP SYSTEM AND REMOVED AFTER THE BIOLOGIST HAS DETERMINED THE ESTABLISHMENT OF WESTERN DICHONDRA.

STUDIO
LANDSCAPE ARCHITECTURE STUDIO
1506 s. coast highway
laguna beach, ca 92651
949 / 494 - 0244
Fax 949 / 494 - 6150
california license 1921

WU RESIDENCE
741 BARRACUDA WAY
LAGUNA BEACH, CA.

FUEL MODIFICATION PLAN
CRAIG DE PFYFFER
DATE: SEPTEMBER 26, 2012
SCALE: 1/8" = 1' - 0"
FILE NAME: Wu_Preliminary_1-22-13.vwx
SHEET: L-4