

SCALE MASTER® II v3.0

ADVANCED DIGITAL PLAN MEASURE

Model 6130

User's Guide



**CALCULATED
INDUSTRIES®**

Putting answers at your fingertips since 1978

TABLE OF CONTENTS

Preliminary Information

Introduction	3
Key Definitions	4
Adjusting the Wheel	8

Using the *Scale Master II*

Imperial/Metric Modes	9
“Rolling” a Measurement	10
Built-in Scales	12
Changing Measurement Units ...	13
Converting Between Scales	14
Locking Scale Settings	15
Using Memory Function	15
Programming Mode	18
Setting Custom Scales	19
Using Custom Scale/Ruler	22
Setting an Auto-Count Value	23
Setting a Constant Value (+K) ...	25
Finding Area and Volume	27
Connecting to a PC (optional) ...	31

Appendix

Error/ Auto-Range Function	34
Interference	34
Battery/ Automatic Shut-Off	35
Battery Replacement	35
Turning the Click & Beep On/Off ..	35
Full Reset/ All Clear	35
Register Values/Settings	36
Specifications	38
Repair and Return	39
Limited Warranty	40

PRELIMINARY INFORMATION

Introduction

The *Scale Master II* Multi-Scale Digital Plan Measure has been specifically designed to simplify take-offs from architectural and engineering drawings.

- ◆ Finds linear measurements of any shape
- ◆ Finds rectangular areas and volumes
- ◆ Converts between scales and dimensions
- ◆ Built-in push button counter
- ◆ Auto-Count function
- ◆ Constant (+K) function
- ◆ Subtract function
- ◆ Eight Custom Scales that let you define and roll in any scale

Key Definitions

[Off/On] – Power On/Off Switch

Turn power On or Off. Turning power Off clears the display and all values previously stored in Memory. Turning the unit Off does not clear scales or modes.

[Lock] – Lock Switch

Locks the mode and scale so that they cannot inadvertently be changed. It is advised to operate in the locked position unless you are specifically setting or changing scales.

[Set] – Set Key

Used to enter a value or to place the unit into a programming mode. If already in a programming mode, **[Set]** will store the displayed value and exit the programming mode.

[Sub] – Subtract Key

Used to toggle the measuring mode between positive and negative direction. While in the negative direction, rolling the unit will subtract the rolled distance from any previously rolled distances or from zero. When **[Sub]** is pressed simultaneously with **[Count]**, **[+K]** or **[M+]**, the unit will subtract the appropriate value.

[Count] – Count Key

Used to increase the Count value by one. Count is active in all modes. Pressing **[Reset]** and **[Count]** simultaneously will clear the count.

[+K] – Constant Key

Used to add a pre-set “constant” value to the displayed measured value. To set a constant value, you press **[Set] [+K]** to place the unit in programming mode.

[Rcl] – Recall Key

Used to recall stored values. When you press **[Rcl] [Rcl]**, the last value rolled is displayed.

[Mode] – Mode Key

Used to cycle through the following scale modes (in sequence):

- 1) Architectural (**ARCH**);
- 2) Engineering 1 (**ENG 1**);
- 3) Engineering 2 (**ENG 2**);
- 4) Map (**MAP**);
- 5) Custom (**CUSTOM**).

When in programming mode, this key moves the cursor back to the previous item programmed.

[Scale] – Scale Key

Used to cycle through the various scales within each scale mode. When in the programming mode, this key moves the cursor forward to the next item to be programmed.

[M+] – Memory Key

Used to add and store a displayed value into Memory. When pressed, the value is added to memory, the display is cleared to “0,” and the indicator “M” lights. When in programming mode, this key advances the flashing digit or units by one.

[Length] – Length Key

Used to store a value in the Length register or recall the current value stored in the Length register.

[Width] – Width Key

Used to store a value in the Width register, or recall the current value stored in the Width register.

[Sq/Cu] – Area/Volume Key

Used to set or view height and calculate area and volume:

- 1) The first press of this key calculates and displays the area using values stored in the Length and Width registers.
- 2) The second press calculates and displays the volume using Length, Width and Height.
- 3) The third press displays the value stored as Height.

When you press **[Set] [Sq/Cu]**, you can set a fixed height. While you are in the programming mode, pressing **[Set]** will store the value as height and return the unit to normal operation.

[Reset]

Used to reset the display. When pressed simultaneously with another key, it clears the value of that key (e.g., **[Reset] [Length]** clears the value stored in the Length register).

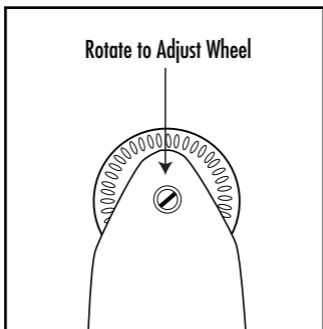

Adjusting the Wheel

The Celcon® polymer wheel can be adjusted for each user's preference. To adjust the wheel, take a small, flat-head jeweler's screwdriver and slightly rotate the screw located near the wheel tip. Rotating the screw about 1/4 to 1/3 turn should be sufficient. Rotating the screw within those two values should adjust the wheel between free spinning (which is too loose) to skidding (which is too tight).

USING THE *SCALE MASTER II*

Imperial/Metric Modes

The *Scale Master II* is set up to use Imperial (English) dimensional units by default. The *Scale Master II* can be set up to use Metric scales by using the following sequence:

- 1) Turn unit off via switch.
- 2) Press and hold **[SUB]** key.
- 3) Turn unit on via switch.
- 4) Release **[SUB]** key.

While in Metric mode, **MET** will remain lit in the scale box.

Repeat the procedure above to switch back to Imperial mode.

“Rolling” a Measurement

To take a measurement with the *Scale Master II*:

- 1) Switch the unit on. If the display does not show zero (0), press the **[Reset]** key to clear the display.
- 2) Select your type of scale by pressing the **[Mode]** key. Then press the **[Scale]** key to select your scale.
- 3) Begin rolling. The display will register your measurements. When you roll the unit, be sure to hold the unit upright (see picture 1 - next page).

Also make sure you start and stop at the exact points you are measuring. Otherwise your roll may not be accurate (see picture 2).

- 4) To store your measurement, press the appropriate key (ex. **[Length]** to label as length, **[Width]** to label as width, etc).
- 5) Press **[Reset]** to reset the unit and begin a new measurement.

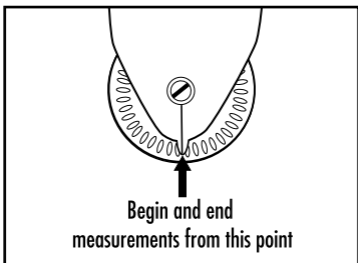
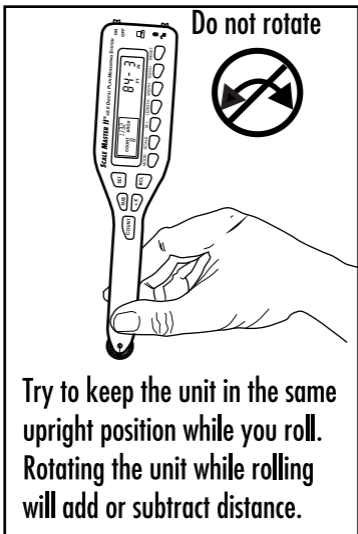

Built-In Scales

Imperial (English) Units

Architect ARCH 1 foot=	Engineer-I ENGI 1 inch=	Engineer-II ENGII 1 inch=	Map MAP 1 inch=
1/32"	10.0'	300.0'	1.0 Mile
1/16"	20.0'	333.3'	1.5 Mi
3/32"	30.0'	400.0'	2.0 Mi
1/8"	40.0'	416.6'	3.0 Mi
3/16"	50.0'	500.0'	4.0 Mi
1/4"	60.0'	583.3'	5.0 Mi
3/8"	83.3'	600.0'	6.0 Mi
1/2"	100.0'	625.0'	10.0 Mi
3/4"	166.6'	666.6'	20.0 Mi
1/1 (1")	200.0'	750.0'	24.0 Mi
3/2 (1½")	250.0'	1,000.0'	25.0 Mi
2/1 (2")		1,200.0'	
3/1 (3")		2,000.0'	
4/1 (4")		3,000.0'	

Metric Units

Architect ARCH	Engineer-I ENGI	Engineer-II ENGI	Map MAP
1:1	1:100.0	1:1,000	1:100k
1:2	1:125.0	1:1,250	1:125k
1:3	1:150.0	1:1,500	1:200k
1:4	1:200.0	1:1,625	1:250k
1:5	1:250.0	1:2,000	1:500k
1:10	1:300.0	1:2,500	1:1,000k
1:20	1:400.0	1:5,000	1:2,000k
1:25	1:500.0	1:6,000	1:2,500k
1:30		1:10k	
1:40		1:12.5k	
1:50		1:20k	
1:75		1:25k	
		1:50k	

Note: See “Imperial/Metric Modes” for instructions on how to change from Imperial and Metric settings.

Changing Measurement Units

A) Press [**Sub**] and [**Scale**] simultaneously to toggle between Feet-Inch and Decimal Feet format (Imperial [English] Mode only).

(cont'd)

(cont'd)

You can also convert values from Imperial Units (English) to Metric Units within the Imperial mode.

- B) Press **[Set]** **[Mode]** and continue pressing **[Mode]** to cycle through available units of measurement.

Converting Between Scales

The *Scale Master II* can automatically convert values between scales. For example, 20 feet rolled in 1/16" scale will be converted to 10 feet in 1/8" scale. You may want to roll a value in one scale and then add that exact value (unconverted) in another scale.

- 1) Roll a value and press the Memory key **[M+]**. Change scales.
- 2) Roll another value and press **[M+]**.
- 3) Press **[Rcl]** **[M+]** to recall the combined total.

Locking Scale Settings

Your *Scale Master II* comes equipped with a lock switch that prevents inadvertently changing drawing scales. When the lock is activated, a lock symbol will be displayed in the LCD. While active, the Scale and Mode cannot be revised (other than removal of the battery).

Using the Memory Function

The Memory function allows you to add rolled or counted values. But you cannot add dimensioned (rolled) and non-dimensioned (counted) values.

To add rolled values:

- 1) Roll the first value*. Press **[M+]**. The display resets to "0," the Memory indicator "M" lights and the value is added to Memory.
- 2) Roll the next value. Press **[M+]**. This value is added to your previous value stored in Memory.

(cont'd)

(cont'd)

- 3) You can continue to add values using the **[M+]** key. Press **[Rcl] [M+]** to review the total in Memory.

***Note:** *For count values, you must press the **[Count]** key to count your value. Then press **[Rcl] [Count]** to move the count value to the main display. Press **[M+]** to add this value to Memory.*

The annunciator “**M**” will display when a value is stored in Memory.

Other Memory Function Keystrokes

[Set] [M+]

Replaces the contents of Memory with the displayed value.

[Set] then [Sub] and [M+] *simultaneously*

Replaces the contents of Memory with the negative of the value in the main display.

[Sub] and [M+] *simultaneously*

Subtracts the value in the main display from the value stored in Memory.

[Reset] and [M+] *simultaneously*

Clears the Memory register.

Programming Mode

The *Scale Master II* allows you to pre-set values into frequently used keys, including:

- ◆ Custom Scales (4 Imp / 4 Met)
- ◆ Auto-Count distance
- ◆ +K (Constant) value
- ◆ Height value

To begin setting values, press the **[Set]** key and then the desired key to be programmed. The following keys are used in programming mode:

[Scale] Advances the cursor to the next item.

[Mode] Moves the cursor back to the previous item.

[M+] Changes the value within an item.

[Reset] Exits the programming mode without saving any values.

[Set] Exits and saves changes.

Setting Custom Scales

You can program and store eight Custom Scales: four in Imperial (English) and four in Metric Units. The default units of measurement for Imperial are Feet-Inches “**FT-IN**” and for Metric, Millimeters “**MM**”. If all custom scale settings are filled, the unit will start over from one.

You can set a custom scale two ways: by “rolling in” a known distance or by setting the exact distance.

“Rolling” a Custom Scale

- 1) Press [**Mode**] until 1:**CUS_x** (x being a number 1-4) appears in the scale box display.
- 2) Press [**Set**] [**Scale**]. “**ROLL**” will appear in the main display.
- 3) Roll desired dimension. “**ROLLING**” now appears in the main display.

(cont'd)

(cont'd)

- 4) Press **[Scale]**. The appropriate annunciator will begin flashing "FT-IN" for Imperial Mode, "MM" for Metric Mode.
- 5) If you want to change the units of measurement, press **[M+]**. You can repeatedly press this key until you reach the desired unit of measurement. Then press the **[Scale]** key to begin setting the distance.
- 6) Press **[M+]** to increment the distance. When you have reached the correct number, press **[Scale]** to advance to the next digit. You can press the **[Mode]** key to move back one digit.
- 7) Once the desired value has been set, press **[Set]** to store value and exit the programming mode.

Note: *Pressing [Reset] will exit the programming mode without saving any value as the Custom Scale.*

Setting a Custom Scale

- 1) Press **[Mode]** until 1:CUS_x (x being a number 1-4) appears in the scale box display.
- 2) Press **[Set] [Scale]**. "ROLL" will appear in the main display.
- 3) Press **[Scale]** again to begin entering the custom scale. The appropriate annunciator will begin flashing "FT-IN" for Imperial Mode, "MM" for Metric Mode.
- 4) If you want to change the units of measurement, press **[M+]**. You can repeatedly press this key until you reach the desired unit of measurement. Then press the **[Scale]** key to begin setting the distance.
- 5) In Imperial mode, the scale will be one inch to whatever you set. In Metric mode, it will be one millimeter to whatever you set. Press **[M+]** to increment the distance. When you have reached the correct number, press **[Scale]** to advance to (cont'd)

(cont'd)

the next digit. You can press the **[Mode]** key to move back one digit.

- 6) Once the desired value has been set, press **[Set]** to store the value and exit the programming mode.

Press **[Rcl] [Scale]** to verify the current custom scale.

Using the Custom Scale/Ruler

The default value (after a full reset) for any custom scale is one-to-one (one Foot equals one Foot). This lets you use your *Scale Master II* as a rolling ruler (in Feet-Inches), which is especially useful for measuring *irregular shapes*.

- 1) To reset your custom scale setting to a one-to-one ratio, press **[Reset]** and **[Sub]** *simultaneously*.
- 2) Then press the **[Mode]** key until the "Custom" mode appears.

Begin rolling. To roll in Decimal Feet instead of Feet-Inches (Imperial only), press **[Sub]** and **[Scale]** *simultaneously*.

Setting an Auto-Count Value

The *Scale Master II* has an Auto-Count mode that allows you to count how many times you've rolled a certain distance. You will hear a beep each time you roll that distance.

To program in Auto-Count mode:

- 1) Press **[Set]** **[Count]** to enter auto-count programming mode. The appropriate annunciator will begin flashing "FT-IN" for Imperial mode, "MM" for Metric mode. The auto-count annunciator "AUTO" will appear in the scale box display.
- 2) If you want to change the units of measurement, press **[M+]**. Repeatedly press this key until you reach the desired unit of measurement. Then press the **[Scale]** key to begin setting the distance.
- 3) Press **[M+]** to increment the distance. When you have reached the correct number, press **[Scale]** to advance to the next digit.

(cont'd)

(cont'd)

- 4) Press **[Set]** to save changes and put the unit into Auto-Count measuring mode.
- 5) Roll a distance. The unit will beep each time you roll the programmed distance. The count number in the scale box will increment.*
- 6) Press **[Set] [Count]** or **[Set] [Reset] [Count]** to exit Auto-Count mode.

***Note:** *The count number will increment until it reaches 999; after that, an asterisk (*) will appear in the scale box display and the unit will continue counting from one. To display the total accumulated count number on the main display, press **[Rcl] [Count]**. Press **[Count]** again (i.e., **[Rcl] [Count] [Count]**) to recall the set auto-count value.*

Setting a Constant Value (+K)

This key is used to add a pre-programmed value to the displayed measured value.

If the value is not “live,” then pressing this key will first reset the display, then add the constant value. When a constant value is added, the value in the display remains a “live” value.

To set a constant:

- 1) Press **[Set] [+K]**. The appropriate annunciator will begin flashing “**FT-IN**” for Imperial Mode, “**MM**” for Metric Mode. The constant annunciator (a small **k**) will appear in the scale box display.
- 2) To change the units of measurement, press **[M+]**. You can repeatedly press this key until you reach the desired unit of measurement. Press **[Scale]** to begin setting the distance. The first zero will start flashing.

- 3) Press **[M+]** to increment the distance. When you have reached the correct number, press **[Scale]** to advance to the next digit. Press **[Mode]** to move back one digit.
- 4) Once the desired value has been set, press **[Set]** to save this value and exit the programming mode.

Other Constant Function Keystrokes

[Rcl] [+K]

Allows you to verify the current constant value.

[Sub] and [+K] *simultaneously*

Subtracts the constant value from the displayed value.

[Reset] and [+K] *simultaneously*

Resets the constant value to zero.

Finding Area and Volume

The *Scale Master II* can calculate area and Volume once you have your values set for Length, Width, and (for Volume calculation only) Height. The Length, Width and Height register values are stored in semi-permanent Memory. These values will not be cleared when you press **[Reset]** by itself. These values will only clear if you:

- 1) Turn off the unit (clears length and width only).
- 2) Press **[Reset]** then the register (clears one value at a time).
- 3) Press **[Sub]** and **[Reset]** *simultaneously* (clears all values).

Once you have rolled or set your Height value, it will be used for all subsequent Volume calculations unless you change it.

Finding Area

- 1) Roll the first dimension and press **[Length]**. This value is stored as the length and the main display will reset to zero (**0**).

- 2) Roll the second dimension and press **[Width]**. This value is stored as the width and the main display will reset to zero.
- 3) Press **[Sq/Cu]** to calculate the area.

Finding Volume

- 1) Roll the first dimension and press **[Length]**.
- 2) Roll the second dimension and press **[Width]**.
- 3) **Storing a Height value** (if you have previously set a Height, skip to step 4):
 - a. **To Roll and Store a Height:**
 - i. Roll the third dimension and press **[Set] [SQ/CU]**. The display will show the rolled value and the unit of measure will begin flashing.
 - ii. If you do not want to change the unit of measure, go to step iii. To change the unit of measure, press **[M+]** until you reach the desired unit.
 - iii. Press **[Set]** to set the value as Height and the display will clear to zero.

b. To Enter and Store a Height:

- i. If you are entering a Height (instead of rolling), press **[Set]** **[Sq/Cu]**.
- ii. If you do not want to change the unit of measure, go to step iii. To change the unit of measure, press **[M+]** until you reach the desired unit.
- iii. Press **[Scale]** to begin setting the digits. The left-most digit will begin flashing.

Press:

[M+] to increment this digit,
[Sub] to decrement the digit,
[Scale] to advance to next digit,
[Mode] to move back one digit.

- iv. Once you are finished setting the digits, press **[Set]** anytime to store the value as Height. The display will clear to zero.

Note: *Once you set your Height, you do not need to enter it again unless you want to change it.*

- 4) To find Volume, press **[Sq/Cu]**. The first press calculates the area; press the **[Sq/Cu]** key again to find volume. Press a third time to display the value stored as Height.

Other Area/Volume Function Keystrokes

[Rcl] [Length]

Displays the value stored in the Length register.

[Rcl] [Width]

Displays the value stored in the Width register.

[Reset] and [Length] *simultaneously*

Clears the value stored as Length.

[Reset] and [Width] *simultaneously*

Clears the value stored as Width.

[Set]

then **[Reset] and [Sq/Cu] *simultaneously***

Clears the value stored as Height.

Connecting to a PC (optional)

The *Scale Master II* has a built-in computer interface connection so that you can use it with estimating and spreadsheet software programs. Like your keyboard, it sends a single value from the main display to the selected cell in your program.

Only the value currently on the *main display* will be sent to the PC. You must send a value in order for the PC to receive it. If you want to send a value, you would first roll or recall the value, then you would press **[Set]** to send the value to the PC.

If you want to temporarily override the send function, press **[Rcl] [Set]**. To cancel the override function, press the **[Set]** key again.

Note: *For more detailed information, see the instructions included with the interface kit.*

You can send a value using the **[Set]** key, then store it as Length, Width, Height, or in the Memory, as you normally would. Remember, for Height, press **[Rcl]** before pressing **[Set]** **[Sq/Cu]** **[Set]**.

[Rcl] **[Set]** **[Sq/Cu]**

Stores the rolled value as height.

[Set] *then* **[Reset]** and **[Sq/Cu]** *simultaneously*
Clears the stored height value.

[Reset] and **[M+]** *simultaneously*,
then **[M+]** *by itself*

Replaces the value previously stored in Memory with the displayed value.

[Reset] and **[M+]** *simultaneously*,
then **[Sub]** and **[M+]** *simultaneously*

Replaces the value previously stored in Memory with the negative of the displayed value.

Auto-Count Function

PC

[Rcl] [Set] [Count]

Enters Auto-Count programming mode. The next press of [Set] exits Auto-Count mode.

[Reset] and [Count] *simultaneously*

Clears the Count value.

[Rcl] [Set] then [Reset] and [Count] *simultaneously*

Exits the Auto-Count mode.

Set Function

PC

[Rcl] [Set]

Used to access the Set function for entering programming mode and accessing special functions without sending a value to the PC.

[Rcl] [Set] [Reset]

Exits the Set function.

Scale Function

PC

[Rcl] [Set] [Scale]

In Custom Scale Mode – puts you into programming mode.

Not in Custom Scale Mode – clears the Set function.

Error/Auto-Range Function

Error Message – If you make an incorrect entry (such as trying to add dimensioned and non-dimensioned values), the *Scale Master II* will display the word “**ERROR.**” Press [**Reset**] to clear.

Auto Range Function – If value is too large to display in the selected units of measurement, the answer will be displayed in the next larger measurement units instead of showing an error (for example: “10,000,000 MM” cannot be displayed, so “10,000 M” will be displayed instead).

Interference

Exposure to direct light or close proximity to cell phones and other electronic devices may cause interference with the *Scale Master* device and result in erroneous measurements.

Battery/Automatic Shut-Off

The *Scale Master II* is powered by two 3-Volt CR-2430 Lithium batteries (6 volts total). To conserve battery power, the unit will shut itself off if it is not used for 12 minutes or less. Press any key to restore power. All registers and settings remain intact, including all temporary registers.

Battery Replacement

To replace the batteries:

- (1) Remove battery door;
- (2) Insert batteries positive side down.



Turning the Click & Beep On/Off

The *Scale Master II* has a built-in wheel click and count beep to let you know when rolling or counting. To toggle the click/beep off or on, press **[Sub]** and **[Mode]** *simultaneously*.

Full Reset/All Clear

To perform a complete reset of the unit and return all registers to their initial default values, press **[Reset]** and **[Sub]** *simultaneously*.

Register Values/Settings

Permanent Values/Settings

The following registers/settings will remain in permanent storage, only changing:

- 1) when the settings are revised;
- 2) when the unit is reset (“All Clear”); or
- 3) when the batteries are changed:

<u>Register Setting</u>	<u>Default Imperial</u>	<u>Default Metric</u>
Mode	ARCH	ARCH
Bell Toggle	ON	ON
Scale	1/32”	1:1
Height	0,000-00	00,000.00
Linear	FT-IN	MM
Area	SQ FT	SQ MM
Volume	CU FT	CU MM
Height	FT-IN	MM
Custom Scales	1:CUSxFT-IN	1:CUS x MM

Semi-Permanent Values/Settings

The following registers/settings are cleared when the *Scale Master II* is powered down:

<u>Register Setting</u>	<u>Default Imperial</u>	<u>Default Metric</u>
Length	0-0	0.00
Width	0-0	0.00
Count	0.	0.
Subtract Mode	OFF	OFF

Specifications

Power Source:

Two 3-Volt CR-2430 lithium batteries.
Approximately 400 hours normal use.

Display Method:

LCD with zero suppression, commas and annunciators.

Display Capacity (Main Display):

9,999,999 (7 digits)

Resolution/Accuracy:

.025 Inch/99.75%

Note: *Based on start/stop point and scale magnitude, users typically experience $\pm 2\%$ - 3% rolling error.*

Dimensions:

7.2" x 1.6" x 0.6"

182mm x 41mm x 15mm

Repair and Return

Warranty, Repair and Return Information

Return Guidelines:

1. Please read the *Warranty* in this User's Guide to determine if your Calculated Industries product remains under warranty **before** calling or returning any device for evaluation or repairs.
2. If your product won't turn on, check the batteries as outlined in the User's Guide.
3. If you need more assistance, please go to our website listed below
4. If you believe you need to return your product, please call a Calculated Industries representative between the hours of 8:00am to 4:00pm Pacific Time for additional information and a Return Merchandise Authorization (RMA).

Call Toll Free: 1-800-854-8075

Outside USA: 1-775-885-4900

www.calculated.com/warranty

Limited Warranty

Calculated Industries, Inc. ("CII") warrants this product against defects in materials and workmanship for a period of one (1) year from the date of original consumer purchase in the U.S. If a defect exists during the warranty period, CII at its option will either repair (using new or remanufactured parts) or replace (with a new or remanufactured unit) the product at no charge.

THE WARRANTY WILL NOT APPLY TO THE PRODUCT IF IT HAS BEEN DAMAGED BY MISUSE, ABUSE, ALTERATION, ACCIDENT, IMPROPER HANDLING OR OPERATION, OR IF UNAUTHORIZED REPAIRS ARE ATTEMPTED OR MADE. SOME EXAMPLES OF DAMAGES NOT COVERED BY WARRANTY INCLUDE, BUT ARE NOT LIMITED TO, BATTERY LEAKAGE, BENDING, A BLACK "INK SPOT" OR VISIBLE CRACKING OF THE LCD WHICH ARE PRESUMED TO BE DAMAGES RESULTING FROM MISUSE OR ABUSE.

To obtain warranty service in the U.S., please go to the website.

A repaired or replacement product assumes the remaining warranty of the original product or 90 days, whichever is longer.

Non-warranty Repair Service — USA

Non-warranty repair covers service beyond the warranty period or service requested due to damage resulting from misuse or abuse.

Contact the CII Authorized Service Provider listed on the back page of the User's Guide to obtain current product repair information and charges. Repairs are guaranteed for 90 days.

Repair Service — Outside the USA

Not all countries have CII Authorized Service Providers or the same warranty and service policies. To obtain warranty or non-warranty repair service for goods purchased outside the U.S., contact the dealer through which you initially purchased the product.

If you cannot reasonably have the product repaired in your area, you may contact CII to obtain current product repair information and charges, including freight and duties.

Disclaimer

CII MAKES NO WARRANTY OR REPRESENTATION, EITHER EXPRESS OR IMPLIED, WITH RESPECT TO THE PRODUCT'S QUALITY, PERFORMANCE, MERCHANTABILITY, OR FITNESS FOR A PARTICULAR PURPOSE. AS A RESULT, THIS PRODUCT, INCLUDING BUT NOT LIMITED TO, KEYSTROKE PROCEDURES, MATHEMATICAL ACCURACY AND PREPROGRAMMED MATERIAL, IS SOLD "AS IS," AND YOU THE PURCHASER ASSUME THE ENTIRE RISK AS TO ITS QUALITY AND PERFORMANCE.

IN NO EVENT WILL CII BE LIABLE FOR DIRECT, INDIRECT, SPECIAL, INCIDENTAL, OR CONSEQUENTIAL DAMAGES RESULTING FROM ANY DEFECT IN THE PRODUCT OR ITS DOCUMENTATION.

The warranty, disclaimer, and remedies set forth above are exclusive and replace all others, oral or written, expressed or implied. No CII dealer, agent, or employee is authorized to make any modification, extension, or addition to this warranty.

Some states do not allow the exclusion or limitation of implied warranties or liability for incidental or consequential damages, so the above limitation or exclusion may not apply to you. This warranty gives you specific rights, and you may also have other rights which vary from state to state.

FCC Class B

Note: This equipment has been tested and found to comply with the limits for a Class B digital device, pursuant to Part 15 of the FCC Rules. These limits are designed to provide reasonable protection against harmful interference in a residential installation. This equipment generates, uses and can radiate radio frequency energy and, if not installed and used in accordance with the instructions, may cause harmful interference to radio communications.

However, there is no guarantee that interference will not occur in a particular installation. If this equipment does cause harmful interference to radio or television reception, which can be determined by turning the equipment off and on, the user is encouraged to try to correct the interference by one or more of the following measures:

- Reorient or relocate the receiving antenna.
- Increase the separation between equipment and receiver.
- Connect the equipment into an outlet on a circuit different from that to which the receiver is connected.
- Consult the dealer or an experienced radio/TV technician for help

This device complies with Part 15 of the FCC Rules. Operation is subject to the following two conditions: (1) this device may not cause harmful interference, and (2) this device must accept any interference received, including interference that may cause undesired operation.

Warning: Changes or modifications to this unit not expressly approved by the party responsible for compliance could void the user's authority to operate the equipment.

How To Reach Calculated Industries



Mail

Calculated Industries, Inc.
4840 Hytech Drive
Carson City, NV 89706 U.S.A.



Phone

1 (775) 885-4900



Fax

1 (775) 885-4949



E-mail

techsup@calculated.com



World Wide Web

www.calculated.com



Software copyrighted and licensed to
Calculated Industries by
Scale Master Technologies, LLC, 2007.

User's Guide copyrighted by Calculated
Industries, 2007.

Scale Master® and Calculated Industries®
are registered trademarks of
Calculated Industries, Inc.

ALL RIGHTS RESERVED

CALCULATED INDUSTRIES®

4840 Hytech Drive
Carson City, NV 89706 U.S.A.
1-800-854-8075 or 1-775-885-4900
Fax: 1-775-885-4949
E-mail: info@calculated.com
www.calculated.com

Designed in the U.S.A.

Printed in China

1/07



UG6130E-F