

N 6.996,300

T.M. #056-2-01-0036
CRP-2 CROWN RIDGE LLC.
DB. 19379 PG. 863
ZONED: C-4

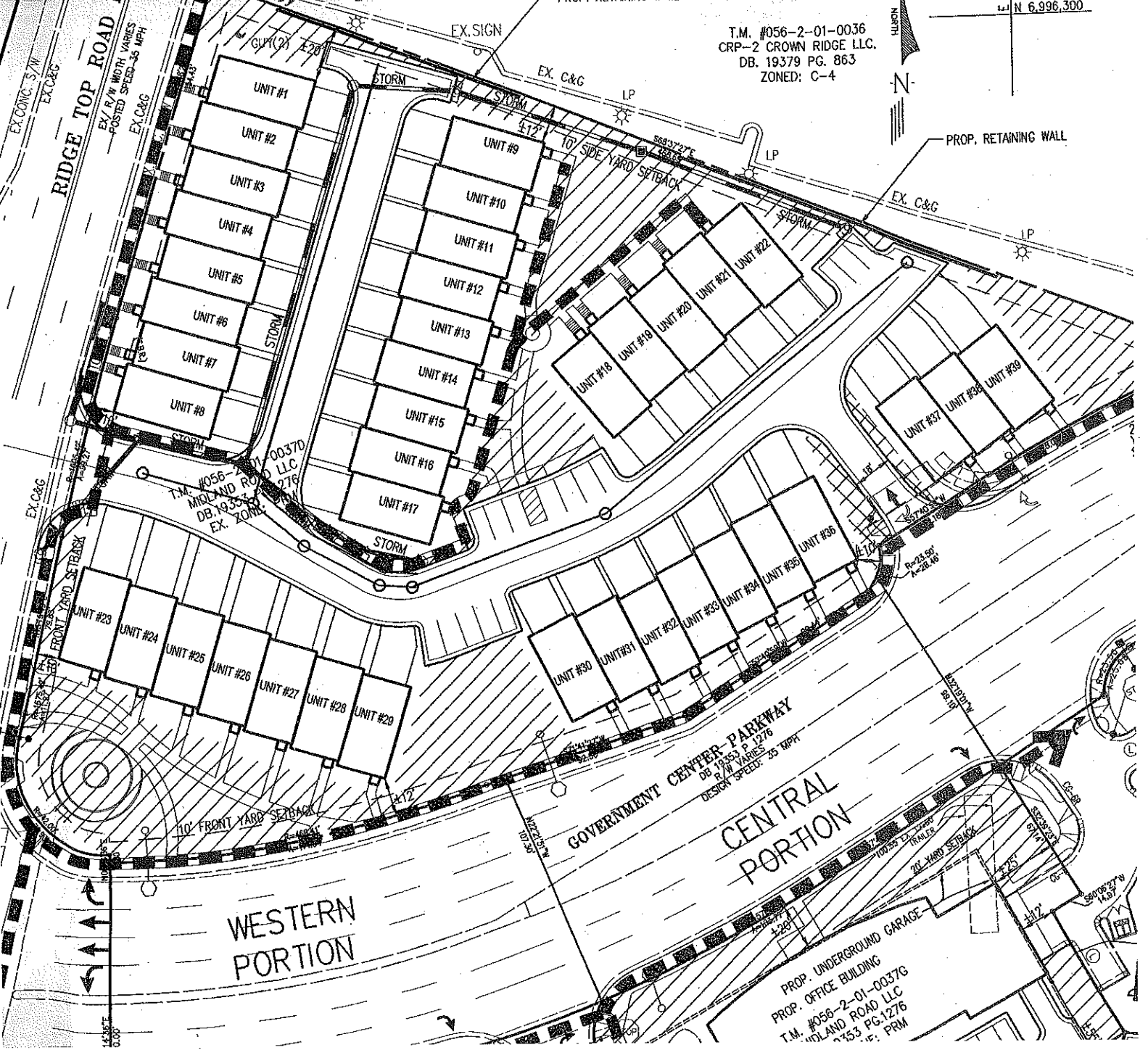

EX. CONC. S/W
EX. C&G
RIDGE TOP ROAD
EX. R/W WIDTH VARIES
POSTED SPEED: 35 MPH
EX. C&G

EX. C&G
FRONT YARD SETBACK
EX. CONC. S/W
EX. C&G

T.M. #056-2-01-0037D
MIDLAND ROAD LLC
DB. 19353 PG. 1276
EX. ZONING: PRM

GOVERNMENT CENTER-PARKWAY
DB. 19353 PG. 1276
R/W VARIES
DESIGN SPEED: 35 MPH

WESTERN PORTION

CENTRAL PORTION

PROP. UNDERGROUND GARAGE
PROP. OFFICE BUILDING
T.M. #056-2-01-0037G
MIDLAND ROAD LLC
DB. 19353 PG. 1276
EX. ZONING: PRM